

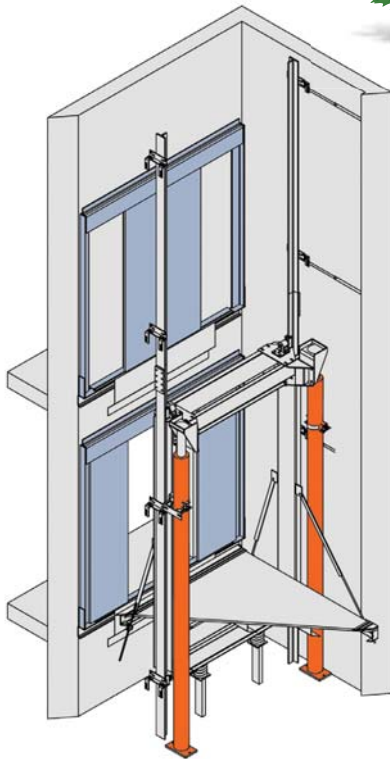

green tip

Vegetable based oil may be used in place of petroleum-based oil.

Call MEI for Sizes or Capacities Outside Listed Ranges **507.245.3060**



Single Opening (F)

Double Opening (F/R)

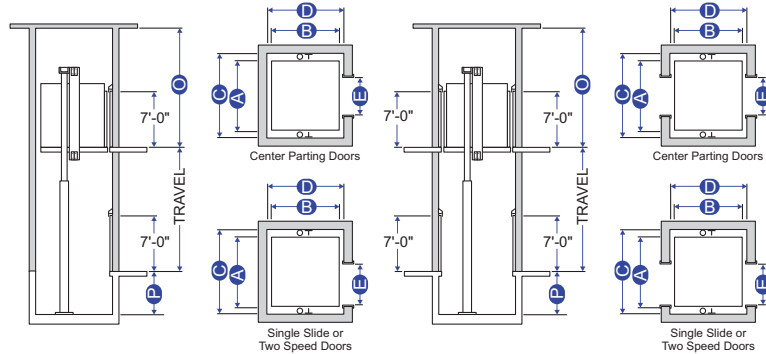

A = Platform Width
B = Platform Depth

C = Hoistway Width
D = Hoistway Depth

E = Clear Door Opening
O = Overhead

P = Pit Depth

Application Summary

This design utilizes two hydraulic jacks and provides maximum structural stability. The jacks, located on each side of the car, are either single-stage or telescopic. The appropriate jack type is determined by the amount of travel and the project conditions. The single-stage jacks are popular for two-stop arrangements, while telescopic jacks are generally used for three- and four-stop projects.

Advantages

- No jack hole is required. This eliminates the cost of drilling and the risk of oil contamination.
- Accommodates front and rear openings in any configuration.
- Available for both low and high capacity cars.

Disadvantages

- Usually requires more overhead than an In-Ground project. The greater the travel, the greater the overhead must be.
- Requires a wider hoistway for the jacks.
- The material cost is typically higher than that of an In-Ground package.

	Capacity (lbs)	Platform A x B	Hoistway C x D	Front/ Rear	Laminate Clear Inside W x D	Door Type	Door Width E	
Low Capacity	2100	6'-0" x 5'-1"	7'-4" x 5'-9" **	F	5'-9" x 4'-3 1/2"	1-SP	3'-0"	
	2100	6'-0" x 5'-8"	7'-4" x 6'-8 1/2" **	F/R	5'-9" x 4'-3 1/2"	1-SP	3'-0"	
	2500	7'-0" x 5'-1"	8'-4" x 5'-9" **	F	6'-9" x 4'-3 1/2"	1-SP	3'-6"	
	2500	7'-0" x 5'-8"	8'-4" x 6'-8 1/2" **	F/R	6'-9" x 4'-3 1/2"	1-SP	3'-6"	
	3000	7'-0" x 5'-6"	8'-4" x 6'-2" **	F	6'-9" x 4'-8 1/2"	1-SP	3'-6"	
	3000	7'-0" x 6'-1"	8'-4" x 7'-1 1/2" **	F/R	6'-9" x 4'-8 1/2"	1-SP	3'-6"	
	3500	7'-0" x 6'-2"	8'-4" x 6'-10" **	F	6'-9" x 5'-4 1/2"	1-SP	3'-6"	
	3500	7'-0" x 6'-9"	8'-4" x 7'-9 1/2" **	F/R	6'-9" x 5'-4 1/2"	1-SP	3'-6"	
	4000	8'-0" x 6'-2"	9'-6" x 7'-0"	F	7'-9" x 5'-3"	2-SP	4'-0"	
	4000	8'-0" x 6'-8"	9'-6" x 7'-11 1/2" **	F/R	7'-9" x 5'-0 1/2"	2-SP	4'-0"	
Hospital	3500H	5'-4" x 8'-4"	6'-10" x 9'-2"	F	5'-1" x 7'-5"	2-SP	3'-6"	
	3500H	5'-4" x 9'-0 1/2"	6'-10" x 10'-4"	F/R	5'-1" x 7'-5"	2-SP	3'-6"	
	4000H	6'-0" x 8'-5"	7'-7" x 9'-3"	F	5'-9" x 7'-6"	2-SP	4'-0"	
	4000H	6'-0" x 9'-1 1/2"	7'-7" x 10'-5"	F/R	5'-9" x 7'-6"	2-SP	4'-0"	
	4500H	6'-0" x 9'-2"	7'-7" x 10'-0"	F	5'-9" x 8'-3"	2-SP	4'-0"	
	4500H	6'-0" x 9'-10 1/2"	7'-7" x 11'-2"	F/R	5'-9" x 8'-3"	2-SP	4'-0"	
	5000H	6'-0" x 9'-7"	7'-8" x 10'-5"	F	5'-9" x 8'-8"	2-SP	4'-0"	
	5000H	6'-0" x 10'-3 1/2"	7'-8" x 11'-7"	F/R	5'-9" x 8'-8"	2-SP	4'-0"	
	High Capacity	6000	7'-0" x 8'-6"	8'-8" x 9'-4"	F	6'-9" x 7'-7"	2-SP	4'-0"
		6000	7'-0" x 9'-2 1/2"	8'-8" x 10'-6"	F/R	6'-9" x 7'-7"	2-SP	4'-0"
8000		8'-4" x 10'-0"	10'-2" x 10'-10"	F	8'-1" x 9'-1"	2-SP	4'-0"	
8000		8'-4" x 10'-8 1/2"	10'-2" x 12'-0"	F/R	8'-1" x 9'-1"	2-SP	4'-0"	
10000		8'-4" x 11'-8 1/2"	10'-4" x 12'-6 1/2"	F	8'-1" x 10'-9 1/2"	2-SP	4'-0"	
10000		8'-4" x 12'-5"	10'-4" x 13'-8 1/2"	F/R	8'-1" x 10'-9 1/2"	2-SP	4'-0"	
12000 *		10'-4" x 11'-6"	12'-6" x 12'-4"	F	10'-1" x 10'-7"	2-SP	4'-0"	
12000 *		10'-4" x 12'-2 1/2"	12'-6" x 13'-6"	F/R	10'-1" x 10'-7"	2-SP	4'-0"	
15000 *	12'-0" x 11'-5"	14'-4" x 12'-3"	F	11'-9" x 10'-6"	2-SP	4'-0"		
15000 *	12'-0" x 12'-1 1/2"	14'-4" x 13'-5"	F/R	11'-9" x 10'-6"	2-SP	4'-0"		

P Pit Depth = 4'-0" • **O** Minimum Overhead (See Below), * Denotes Minimum Overhead = 12'-5" • Cab Height = 8'-0" • ** Hoistway width may vary for two-stage.

Guidelines for determining overhead required:

For 1 Stage Jack

- A) Car Speed = Up to 150 FPM
- B) Top Overtravel = 5"
- C) Bottom Overtravel = 12"
- D) Pit Depth = 4'-0"
- E) Cab Height = 8'-0"

For 2 Stage Jack

- A) Car Speed = Up to 150 FPM
- B) Top Overtravel = 12"
- C) Bottom Overtravel = 10"
- D) Pit Depth = 4'-0"
- E) Cab Height = 8'-0"

One Stage Jack Overhead Requirement:

Minimum of 12'-0" overhead required for 12'-0" of travel and under. If over 12'-0" travel, overhead must equal or be greater than total travel.

Two Stage Jack Overhead Requirement:

Minimum of 12'-8" overhead required for 20' of travel and under. Add 1/2" to 12'-8" for every additional 1" of travel over 20'-0".



Do not use hoistway dimensions for construction purposes. Different code year adoptions and local code variations may affect the hoistway size. Verify all dimensions with MEI prior to construction.