

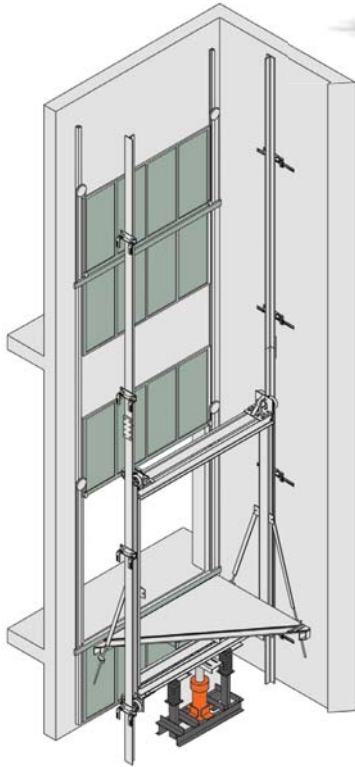

green tip

Vegetable based oil may be used in place of petroleum-based oil.

Call MEI for Sizes or Capacities Outside Listed Ranges **507.245.3060**



Single Opening (F)

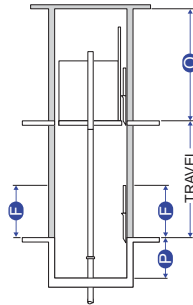

Double Opening (F/R)

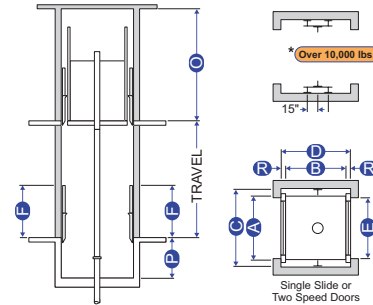

- A** = Platform Width
- B** = Platform Depth
- C** = Hoistway Width
- D** = Hoistway Depth
- E** = Clear Door Width
- F** = Clear Door Height

- O** = Overhead
- P** = Pit Depth
- R** = Door Clearance
- R** = 5" for Regular Type Doors
- R** = 6 3/4" for Pass Type Doors

*** Over 10,000 lbs.**
For capacities over 10,000 lbs., rail bracket fastening may require beam support as shown. A Structural Engineer needs to determine that the hoistway structure will withstand the rail forces shown on the layout drawing.

Application Summary

This is the traditional design used for decades. It utilizes a hydraulic jack installed in the ground. The jack is located directly under the car, near the center of the platform.

Advantages

- Usually the lowest material cost application.
- Accommodates front and rear openings in any configuration.
- No extensive pit or overhead is required.
- Available for both low and high capacity cars.
- Of all the application types, this equipment package is the easiest to install.

Disadvantages

- Oil contamination in the ground is possible. As a precaution, the jack can be enclosed in PVC pipe. Areas with frequent seismic activity will have the greatest risk of oil contamination.
- The jack must go down into the ground roughly the same distance as the desired travel (*multi-stage jacks can reduce this distance*). Drilling a jack hole is expensive and may be nearly impossible in certain structural or geologic conditions.

Cap.	Platform A x B	Hoistway With Power Regular Doors C x D	Hoistway With Power Pass Doors C x D	Pit Depth P	Front (F) Rear (R)	Clear Inside With Single Section	Clear Inside With Two Section	Door Width And Height E x F
4000	7'-0" x 8'-0"	8'-8" x 8'-8"	8'-8" x 8'-9 3/4"	4'-6"	F	6'-8" x 7'-7"	6'-8" x 7'-4 1/2"	6'-8" x 8'-0"
4000	7'-0" x 8'-0"	8'-8" x 8'-10"	8'-8" x 9'-1 1/2"	4'-6"	F/R	6'-8" x 7'-6"	6'-8" x 7'-1"	6'-8" x 8'-0"
5000	8'-0" x 9'-0"	9'-10" x 9'-8"	9'-10" x 9'-9 3/4"	4'-6"	F	7'-8" x 8'-7"	7'-8" x 8'-4 1/2"	7'-8" x 8'-0"
5000	8'-0" x 9'-0"	9'-10" x 9'-10"	9'-10" x 10'-1 1/2"	4'-6"	F/R	7'-8" x 8'-6"	7'-8" x 8'-1"	7'-8" x 8'-0"
6000	10'-4" x 10'-0"	12'-2" x 10'-8"	12'-2" x 10'-9 3/4"	4'-6"	F	10'-0" x 9'-7"	10'-0" x 9'-4 1/2"	10'-0" x 8'-0"
6000	10'-4" x 10'-0"	12'-2" x 10'-10"	12'-2" x 11'-1 1/2"	4'-6"	F/R	10'-0" x 9'-6"	10'-0" x 9'-1"	10'-0" x 8'-0"
8000	10'-4" x 12'-0"	12'-4" x 12'-8"	12'-4" x 12'-9 3/4"	4'-6"	F	10'-0" x 11'-7"	10'-0" x 11'-4 1/2"	10'-0" x 8'-0"
8000	10'-4" x 12'-0"	12'-4" x 12'-10"	12'-4" x 13'-1 1/2"	4'-6"	F/R	10'-0" x 11'-6"	10'-0" x 11'-1"	10'-0" x 8'-0"
10000	10'-4" x 14'-0"	12'-4" x 14'-8"	12'-4" x 14'-9 3/4"	4'-6"	F	10'-0" x 13'-7"	10'-0" x 13'-4 1/2"	10'-0" x 8'-0"
10000	10'-4" x 14'-0"	12'-4" x 14'-10"	12'-4" x 15'-1 1/2"	4'-6"	F/R	10'-0" x 13'-6"	10'-0" x 13'-1"	10'-0" x 8'-0"
12000	12'-4" x 12'-0"	14'-4" x 12'-8"	14'-4" x 12'-9 3/4"	4'-6"	F	12'-0" x 11'-7"	12'-0" x 11'-4 1/2"	12'-0" x 8'-0"
12000	12'-4" x 12'-0"	14'-4" x 12'-10"	14'-4" x 13'-1 1/2"	4'-6"	F/R	12'-0" x 11'-6"	12'-0" x 11'-1"	12'-0" x 8'-0"
15000	12'-4" x 16'-0"	14'-4" x 16'-8"	14'-4" x 16'-9 3/4"	5'-0"	F	12'-0" x 15'-7"	12'-0" x 15'-4 1/2"	12'-0" x 8'-0"
15000	12'-4" x 16'-0"	14'-4" x 16'-10"	14'-4" x 17'-1 1/2"	5'-0"	F/R	12'-0" x 15'-6"	12'-0" x 15'-1"	12'-0" x 8'-0"
20000	12'-4" x 20'-0"	14'-4" x 20'-8"	14'-4" x 20'-9 3/4"	5'-0"	F	12'-0" x 19'-7"	12'-0" x 19'-4 1/2"	12'-0" x 8'-0"
20000	12'-4" x 20'-0"	14'-4" x 20'-10"	14'-4" x 21'-1 1/2"	5'-0"	F/R	12'-0" x 19'-6"	12'-0" x 19'-1"	12'-0" x 8'-0"
25000	14'-4" x 20'-0"	16'-4" x 20'-8"	16'-4" x 20'-9 3/4"	5'-6"	F	14'-0" x 19'-5 1/2"	14'-0" x 19'-3"	14'-0" x 8'-0"
25000	14'-4" x 20'-0"	16'-4" x 20'-10"	16'-4" x 21'-1 1/2"	5'-6"	F/R	14'-0" x 19'-3"	14'-0" x 18'-10"	14'-0" x 8'-0"
Automobile Lifts								
8000	9'-4" x 21'-8"	11'-0" x 22'-4"	11'-0" x 22'-5 3/4"	4'-6"	F	9'-0" x 21'-3"	9'-0" x 21'-0 1/2"	9'-0"
8000	9'-4" x 21'-8"	11'-0" x 22'-6"	11'-0" x 22'-9 1/2"	4'-6"	F/R	9'-0" x 21'-2"	9'-0" x 20'-9"	9'-0"

- Notes:
- Overhead dimensions are based on 6 foot high car gate.
 - Two section car gates are not recommended for high usage installations or wide openings.
 - For extra high door opening requirements, or special conditions, consult your representative.

Standard Cab Height H = 8'-0"
Minimum Overhead for Single Section Gates
O = 14'-6"
Minimum Overhead for Two Section Gates
O = 12'-4"

⚠ Do not use hoistway dimensions for construction purposes. Different code year adoptions and local code variations may affect the hoistway size. Verify all dimensions with MEI prior to construction.